

# P.V.C. PIPE FITTINGS

**DEAN BENNETT SUPPLY CO**  
**1770 E. 69th AVE. DENVER, CO 80229**  
**PH 303-286-1500 FAX 303-286-0001**  
**TOLL FREE 800-621-4291**

Page 41

**9 - 7 - 11 NET PRICES**

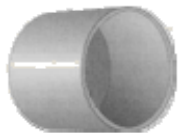

<b>CAPS - - - Slip (on to pipe)</b>								
3/4"	7PCAP	\$ .31	1-1/2"	15PCAP	\$ .76	4"	40PCAP	\$ 7.29
1"	10PCAP	\$ .49	2"	20PCAP	\$ .91			
1-1/4"	12PCAP	\$ .70	3"	30PCAP	\$ 3.21			



<b>MALE ADAPTERS - - - Slip (on to pipe) x Male Pipe Thread</b>								
3/4"	7PMA	\$ .30	1-1/2"	15PMA	\$ .88	3"	30PMA	\$ 4.96
1"	10PMA	\$ .53	2"	20PMA	\$ 1.15	4"	40PMA	\$ 6.33
1-1/4"	12PMA	\$ .65	2-1/2"	25PMA	\$ 3.39			

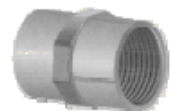

<b>FEMALE ADAPTERS - - - Slip (on to pipe) x Female Pipe Thread</b>								
3/4"	7PFA	\$ .42	1-1/2"	15PFA	\$ .88	4"	40PFA	\$ 6.63
1"	10PFA	\$ .49	2"	20PFA	\$ 1.18			
1-1/4"	12PFA	\$ .76	3"	30PFA	\$ 4.00			



<b>THREADED PVC DROP PIPE COUPLINGS (Female Thread x Female Thread)</b>								
1"	10PDPCOUP	\$ 1.80	1-1/4"	12PDPCOUP	\$ 2.45	1-1/2"	15PDPCOUP	\$ 4.05
			2"	20PDPCOUP	\$ 4.45			



<b>PVC INSERT MALE ADAPTERS - - - (Barb x Male Pipe Thread)</b>								
1/2"	5IPMA	\$ .36	1"	10IPMA	\$ .45	1-1/2"	15IPMA	\$ .80
3/4"	7IPMA	\$ .43	1-1/4"	12IPMA	\$ .71	2"	20IPMA	\$ 1.52



<b>PVC INSERT COUPLINGS - - - (Barb x Barb)</b>								
3/4"	7IPCUP	\$ .43	1-1/4"	12IPCUP	\$ .67	2"	20IPCUP	\$ 1.51
1"	10IPCUP	\$ .46	1-1/2"	15IPCUP	\$ .80			



<b>PVC INSERT 90 Degree ELBOWS - - - (Barb x Barb)</b>								
3/4"	7IPL	\$ .86	1-1/4"	12IPL	\$ 1.07	2"	20IPL	\$ 1.77
1"	10IPL	\$ .95	1-1/2"	15IPL	\$ 1.26			



<b>PVC INSERT TEES - - - (Barb x Barb x Barb)</b>								
3/4"	7IPT	\$ .84	1-1/4"	12IPT	\$ 1.71	2"	20IPT	\$ 3.82
1"	10IPT	\$ 1.09	1-1/2"	15IPT	\$ 1.94			



<b>PVC INSERT FEMALE ADAPTERS - - - (Barb x Female Pipe Thread)</b>								
3/4"	7IPFA	\$ 1.71	1-1/4"	12IPFA	\$ 2.33	2"	20IPFA	\$ 5.01
1"	10IPFA	\$ 1.90	1-1/2"	15IPFA	\$ 2.96			



<b>PVC COMPRESSION COUPLING - - - PVC Repair Coupling</b>								
3/4"	7PCOMPCOUP	\$ 4.10	1-1/4"	12PCOMPCOUP	\$ 8.25	3"	30PCOMPCOUP	\$ 26.90
1"	10PCOMPCOUP	\$ 5.25	1-1/2"	15PCOMPCOUP	\$ 8.40	4"	40PCOMPCOUP	\$ 44.50
			2"	20PCOMPCOUP	\$ 11.10	6"	60PCOMPCOUP	\$ 99.75

**FITTINGS QUALIFY FOR OUR \$ 1,000.00 FREIGHT PREPAID ORDER POLICY**